

## AIRCRAFT MAINTENANCE MANUAL

\*\*ON A/C 15001–15990

### **TASK 32–43–26–210–801 (Config A02)**

#### **General Visual Inspection of the Brake–Unit Assembly Wear–Pin Indicator**

MRB 324000–204

#### 1. General

- A. The maintenance procedure that follows is for the visual inspection of the brake–unit assembly wear–pin indicator (written as the "wear–pin indicator" in this procedure). There are two brake wear– pin indicators installed on each brake assembly of the main landing gear.

#### 2. Job Set–Up Information

- A. Reference Information

MANUAL NO	REFERENCE	DESIGNATION
CSP–B–001	<a href="#">TASK 10–11–01–910–801</a>	Set the Parking Brake
CSP–B–001	<a href="#">TASK 10–11–01–910–802</a>	Release the Parking Brake
CSP–B–001	<a href="#">TASK 12–00–06–862–801</a>	Pressurize Hydraulic System No. 1 and No. 2
CSP–B–001	<a href="#">TASK 12–00–06–862–802</a>	Release Hydraulic Pressure of System No. 1 and No. 2
CSP–B–001	<a href="#">TASK 12–00–06–862–803</a>	Pressurize Hydraulic System No. 3
CSP–B–001	<a href="#">TASK 12–00–06–862–804</a>	Release Hydraulic Pressure of System No. 3
CSP–B–001	<a href="#">TASK 12–00–00–867–801</a>	Standard Aircraft Configuration for Maintenance
CSP–B–001	<a href="#">TASK 29–00–00–910–801</a>	Hydraulic Safety Precautions
CSP–B–001	<a href="#">TASK 32–41–01–000–801</a>	Removal of the Main Wheel and Tire Assembly
CSP–B–001	<a href="#">TASK 32–41–01–400–801</a>	Installation of the Main Wheel and Tire Assembly
CSP–B–001	<a href="#">TASK 32–43–26–000–801</a>	Removal of the Brake Unit Assembly
CSP–B–001	<a href="#">TASK 32–43–26–400–801</a>	Installation of the Brake Unit Assembly

#### 3. Job Set–Up

- A. Make sure that the aircraft is in the standard configuration for maintenance ([TASK 12–00–00–867–801](#)).

CSP B–001 – MASTER  
EFFECTIVITY:  
See first effectivity on page 605 of 32–43–26



## AIRCRAFT MAINTENANCE MANUAL

**WARNING:** OBEY ALL HYDRAULIC SAFETY PRECAUTIONS WHEN YOU DO WORK ON THE HYDRAULIC SYSTEM AND HYDRAULIC SYSTEM COMPONENTS. YOU CAN CAUSE INJURY TO PERSONS AND DAMAGE TO THE EQUIPMENT.

- B. Obey all the hydraulic safety precautions ([TASK 29-00-00-910-801](#)).
- C. Pressurize Hydraulic System No. 2 ([TASK 12-00-06-862-801](#)).
- D. Pressurize Hydraulic System No. 3 ([TASK 12-00-06-862-803](#)).
- E. Set the parking brake ([TASK 10-11-01-910-801](#)).

4. Procedure

[Refer to Figure 602](#)

- A. Do the visual inspection of the wear-pin indicator (1) as follows:

- (1) Examine the wear-pin indicators (1) on the inboard and outboard brake assembly for damage, corrosion, and security.

**NOTE:** If one of the two wear-pin indicators (1) is missing or broken examine only the other one.

- (2) Make sure the end of the wear-pin indicator (1) extends out of the brake housing subassembly (2).
- (3) If the end of the wear-pin indicator (1) is flush with the brake housing subassembly (2), examine the second wear pin indicator (1).
- (4) Make sure the end of the second wear-pin indicator (1) extends out of the brake housing subassembly (2).
- (5) If one of the two wear-pin indicators (1) is missing or broken, do as follows:
  - (a) If necessary, remove the mainwheel and tire assembly ([TASK 32-41-01-000-801](#)).
  - (b) Make sure that the wear-pin indicator (1) has not fallen into the brake.
  - (c) Make sure that there is no damage to the wheel and the brake.
  - (d) If necessary, install the mainwheel and the tire assembly ([TASK 32-41-01-400-801](#)).
- (6) If the second wear-pin indicator (1) is flush with the brake housing subassembly (2), do as follows:
  - (a) Remove the brake unit assembly ([TASK 32-43-26-000-801](#)).
  - (b) Install a new brake unit assembly ([TASK 32-43-26-400-801](#)).

**AIRCRAFT MAINTENANCE MANUAL**

- (7) If both wear pins are missing, do as follows:
- (a) If necessary, remove the mainwheel and tire assembly ([TASK 32-41-01-000-801](#)).
  - (b) Make sure that the wear-pin indicator (1) has not fallen into the brake.
  - (c) Make sure that there is no damage to the wheel and the brake.
  - (d) Make sure parking brake is set.
  - (e) Measure the distance between the brake housing (2) and the pressure plate (3).
  - (f) If the distance between the brake housing (2) and the pressure plate (3) is more than 2.360 in. (59.94 mm.) do as follow:
    - 1 Remove the brake unit assembly ([TASK 32-43-26-000-801](#)).
    - 2 Install a new brake unit assembly ([TASK 32-43-26-400-801](#)).
  - (g) If removed, install the mainwheel and the tire assembly ([TASK 32-41-01-400-801](#)).

5. Close Out

- A. Remove all tools, equipment, and unwanted materials from the work area.
- B. If necessary, release the parking brake ([TASK 10-11-01-910-801](#)).
- C. If necessary, release the hydraulic pressure of system No. 2 ([TASK 12-00-06-862-802](#)).
- D. If necessary, release the hydraulic pressure of system No. 3 ([TASK 12-00-06-862-804](#)).

## AIRCRAFT MAINTENANCE MANUAL

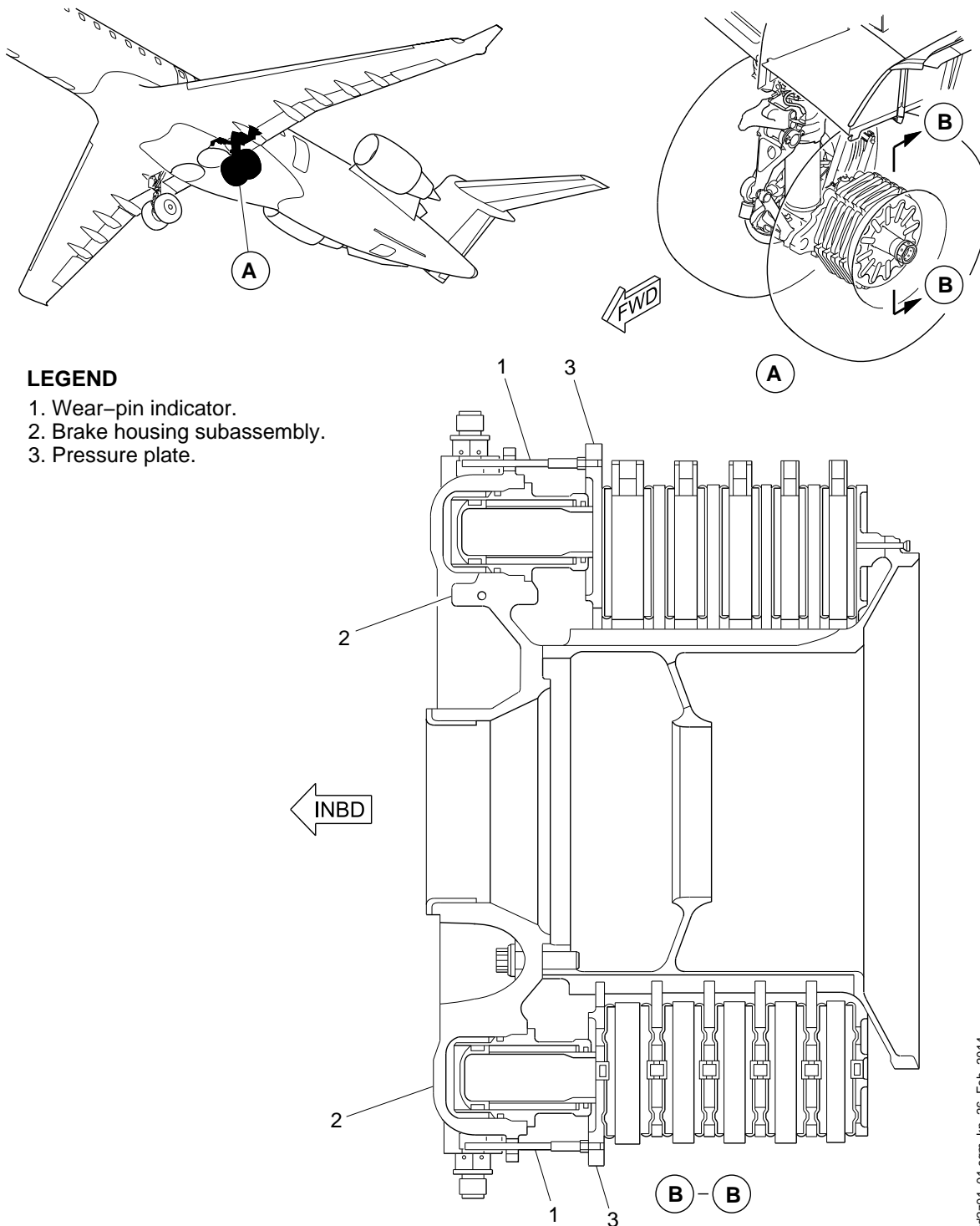

basd201\_01.cgm, kp. 26-Feb-2014

Brake-Unit Assembly Wear-Pin Indicator-Inspection/Check – Inspection/Check  
Figure 602